



edge

Project: _____ Type: _____

Item No. _____

Location: _____

Notes: _____



standard features

- Operating voltage: 24V
- Lamp source: LED
- LED lifetime: 50,000 hours (ta=95°F, 35°C)
- Lumens: varies by length (see ordering information)
- Color temperature: 2700K, 3000K, 3500K, 4000K
- Fixture length: 5 lengths (see ordering information)
- Power supply (driver): 30W, 75W, 96W
- Power cord: included with each power supply
- Bright and consistent illuminance
- Diffused lens ensures no LED imaging (i.e. pixel free)
- Can be linked direct or with connecting cables
- Installation method: metal mounting clips - 0° (screws provided)

dimensions (inches/mm)

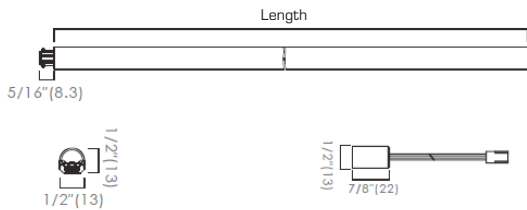

options

- Metal mounting clips - 45°
- Magnetic mounting clips - 0° and 45°
- Connecting cables
- Other LED color temperatures (contact factory)



direct connection



cable connection



beam spread

		edge-8-24V		edge-12-24V		edge-23-24V		edge-35-24V		edge-45-24V	
		3000K	4000K	3000K	4000K	3000K	4000K	3000K	4000K	3000K	4000K
12"	41-5/8"	64	64	103	103	129	129	147	147	146	146
18"	62-3/8"	31	31	50	50	72	72	88	88	90	90
24"	83-1/8"	18	18	29	29	45	45	59	59	63	63
30"	103-7/8"	12	12	19	19	31	31	42	42	46	46
H	D	275 lm	275 lm	440 lm	440 lm	825 lm	825 lm	1265 lm	1265 lm	1650 lm	1650 lm

foot-candle (fc)

edge

how to order using item numbers
(example: edge-8D2790-110S-C)

product -	length (inches)	lens	color temp (K)	CRI -	beam angle	finish -	installation
edge	8 7 7/8" (200mm) 12 11 13/16" (300mm) 23 22 7/16" (570mm) 35 34 1/4" (870mm) 45 44 7/8" (1140mm)	D diffused	27 2700K 30 3000K 35 3500K 40 4000K	90	110 - 110°	S silver	C mounting clips - 0° (included with fixture)

ordering information fixtures

item number	model	description				maximum fixtures per driver (derated to account for voltage drop)		
		related input	ra	wattage	lumens	30W	75W	96W
edge-8D2790-110S-C edge-8D3090-110S-C edge-8D3590-110S-C edge-8D4090-110S-C	edge-8-24V	24VDC	90	2.5W	275 lm	10	27	34
edge-12D2790-110S-C edge-12D3090-110S-C edge-12D3590-110S-C edge-12D4090-110S-C	edge-12-24V	24VDC	90	4W	440 lm	6	17	21
edge-23D2790-110S-C edge-23D3090-110S-C edge-23D3590-110S-C edge-23D4090-110S-C	edge-23-24V	24VDC	90	7.5W	825 lm	3	9	12
edge-35D2790-110S-C edge-35D3090-110S-C edge-35D3590-110S-C edge-35D4090-110S-C	edge-35-24V	24VDC	90	11.5W	1265 lm	2	6	8
edge-45D2790-110S-C edge-45D3090-110S-C edge-45D3590-110S-C edge-45D4090-110S-C	edge-45-24V	24VDC	90	15W	1650 lm	1	4	6

Each fixture includes: metal mounting clips (2), screws (2), end cap (1)

ordering information
drivers

item number	catalog number	description	voltage		dimensions (inches)			# ports	dimming
			input	output	L	W	H		
8900-0015	DVR-NA159-3024FA-4A6	30W driver w/5' power cord	100 - 120 AC	24 DC	6 5/16"	2"	7/8"	4	no
8900-0017	DVR-NA159-7524LA-12A6	75W driver w/5' power cord	100 - 120 AC	24 DC	7 1/16"	2 3/8"	1 3/16"	12	no
8900-0019	DVR-NA383-9624DLA-DG6-12A6	96W driver w/7' power cord	120 - 250 AC	24 DC	9 9/16"	1 13/16"	1 9/16"	12	yes (0-10V)



8900-0015



8900-0017



8900-0019

wiring example



ordering information
accessories

item number	description
edge-IC59	input cable - 59" (1499mm) required to connect fixture to driver
edge-CC2	connecting cable - 2" (50mm)
edge-CC12	connecting cable - 12" (300mm)
edge-MC	metal mounting clips - 0°
edge-MC45	metal mounting clips - 45°
edge-MAGC	magnetic mounting clips - 0°
edge-MAGC45	magnetic mounting clips - 45°
edge-EXL98	extension cord - 98" (2489 mm)

metal mounting clip installation

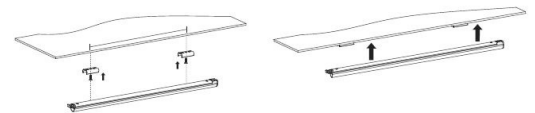

magnetic mounting clip installation



connecting cable

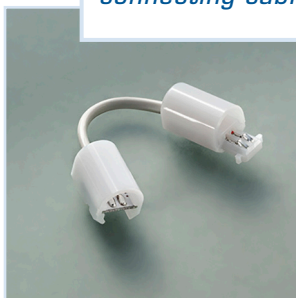

input cable
(required to connect
fixture to driver)



metal
mounting clips



magnetic
mounting clips

